

建設地測量表

Table with columns: 測点 (Point), X, Y, and coordinates. It lists points K171 through K144 with their respective X and Y values.

建設地測量表

Table with columns: 測点 (Point), X, Y, and coordinates. It lists points K171 through K144 with their respective X and Y values.

建設地測量表

Table with columns: 測点 (Point), X, Y, and coordinates. It lists points K171 through K144 with their respective X and Y values.

建設地測量表

Table with columns: 測点 (Point), X, Y, and coordinates. It lists points K171 through K144 with their respective X and Y values.

建設地測量表

Table with columns: 測点 (Point), X, Y, and coordinates. It lists points K171 through K144 with their respective X and Y values.

建設地測量表

Table with columns: 測点 (Point), X, Y, and coordinates. It lists points K171 through K144 with their respective X and Y values.

建設地測量表

Table with columns: 測点 (Point), X, Y, and coordinates. It lists points K171 through K144 with their respective X and Y values.

建設地測量表

Table with columns: 測点 (Point), X, Y, and coordinates. It lists points K171 through K144 with their respective X and Y values.

建設地測量表

Table with columns: 測点 (Point), X, Y, and coordinates. It lists points K171 through K144 with their respective X and Y values.

建設地測量表

Table with columns: 測点 (Point), X, Y, and coordinates. It lists points K171 through K144 with their respective X and Y values.

建設地測量表

Table with columns: 測点 (Point), X, Y, and coordinates. It lists points K171 through K144 with their respective X and Y values.

建設地測量表

Table with columns: 測点 (Point), X, Y, and coordinates. It lists points K171 through K144 with their respective X and Y values.

建設地測量表

Table with columns: 測点 (Point), X, Y, and coordinates. It lists points K171 through K144 with their respective X and Y values.

建設地測量表

Table with columns: 測点 (Point), X, Y, and coordinates. It lists points K171 through K144 with their respective X and Y values.

建設地測量表

Table with columns: 測点 (Point), X, Y, and coordinates. It lists points K171 through K144 with their respective X and Y values.

建設地測量表

Table with columns: 測点 (Point), X, Y, and coordinates. It lists points K171 through K144 with their respective X and Y values.

建設地測量表

Table with columns: 測点 (Point), X, Y, and coordinates. It lists points K171 through K144 with their respective X and Y values.

建設地測量表

Table with columns: 測点 (Point), X, Y, and coordinates. It lists points K171 through K144 with their respective X and Y values.

建設地測量表

Table with columns: 測点 (Point), X, Y, and coordinates. It lists points K171 through K144 with their respective X and Y values.

建設地測量表

Table with columns: 測点 (Point), X, Y, and coordinates. It lists points K171 through K144 with their respective X and Y values.

建設地測量表

Table with columns: 測点 (Point), X, Y, and coordinates. It lists points K171 through K144 with their respective X and Y values.

建設地測量表

Table with columns: 測点 (Point), X, Y, and coordinates. It lists points K171 through K144 with their respective X and Y values.

建設地測量表

Table with columns: 測点 (Point), X, Y, and coordinates. It lists points K171 through K144 with their respective X and Y values.

建設地測量表

Table with columns: 測点 (Point), X, Y, and coordinates. It lists points K171 through K144 with their respective X and Y values.

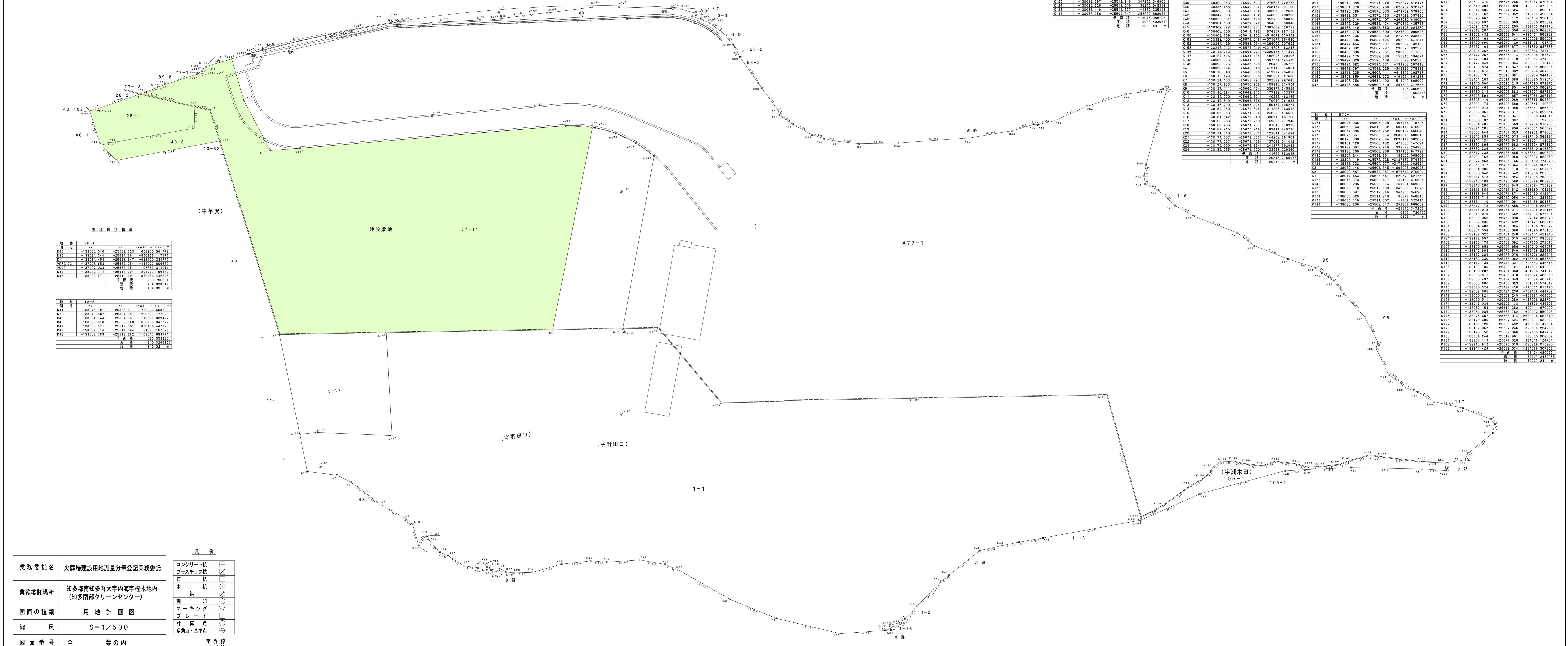
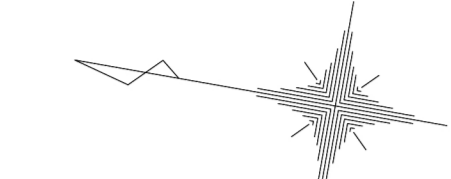

Table with 2 columns: 業務委託名 (Business Commission Name) and 業務委託場所 (Business Commission Location). It lists '火葬場建設用地測量分筆登記業務委託' and '知多郡南知多町大字内海字榎木地内(知多南部クリーンセンター)'.

Table with 2 columns: 図面の種類 (Drawing Type) and 縮尺 (Scale). It lists '用地計画図' and 'S=1/500'.

Table with 2 columns: 縮尺 (Scale) and 図面番号 (Drawing Number). It lists 'S=1/500' and '全業の内'.